



PRESSURIZING TANK TOP (PTT)

USER MANUAL



READ AND UNDERSTAND THE SAFETY PRECAUTIONS BEFORE OPERATING THIS DEVICE

SAFETY

Please ensure you have read and fully understood the safety precautions before operating this appliance. Instructions for use of this product will vary depending on the formulation and application of the product. Always read the formulation label when preparing your solution.

Always comply with any requirements for Personal Protective Equipment (PPE) as required by the formulation label.

This appliance is to be kept out of reach from children. However, it can be used by children aged 8 years and above, as well as persons with reduced physical, sensory or mental capacities or lack of experience and knowledge, provided they have been given supervision or instruction concerning use of the appliance in a safe way, and understand the hazards involved.

Do not use the power supply unit provided with this appliance outdoors or in wet/humid conditions.

Children should not play with, clean, or maintain the appliance.

Do not use this appliance when plugged into the power supply unit.

The appliance is only to be charged with the power supply unit provided with the appliance.

This sprayer top can be used with water-based, oil-based, and solvent-based formulations.

DESCRIPTION

The PTT has an on-demand pump that operates only when the pressure in the tank drops to about 23 psi (1.5 bar). The pump will shut off automatically when the pressure reaches 30 psi (2.0 bar). Pressure in the sprayer tank will fluctuate between 23 and 30 psi during spraying.

The PTT requires approximate 2.5 minutes to pressurize the tank when it is filled to the quantity tick mark on the side of the tank. The PTT will deliver approximately 27 to 30 gallons (102 to 113 liters) on a full battery charge.

Dual-voltage charger operates from a three-wire power system in which one is a ground. Specifications: Input: AC 100-240V, 50-60Hz, 1.0A. Output: DC 12.6V, 2.0A. The battery in the PTT recharges in about 4 hours.



Compatibility. The PTT is compatible with Primeline/VersaFoamer HH stainless steel tanks made by B&G Equipment. Use on other tanks is not sanctioned. It is not intended for use with the B&G funnel-top concrete sprayer (#12014006) or the funnel-top chemical resistant sprayer (#12013900).

LEGACY PART #	ORDER #
22046000	1108004818

BEFORE USE

- Charge the battery for at least 4 hours with the wall charger.
- Inspect the bottom of the PTT to be certain the tank gasket is firmly in place.
- Start with a sprayer tank that is filled to the line on the tank (1 gallon/3.785 liters in a 1-gallon/3.785-liter tank). Do not over-fill the tank when using the PTT.

OPERATION

Charging the Battery

- PTT has an internal battery that can be fully charged in about 4 hours using the wall charger. The battery charger has lights to indicate the charging status.
- PTT battery can be charged while the unit is attached to a sprayer tank, or it can be removed from the tank and charged separately.
- When the battery is weak it will take longer to return the tank pressure to 30 psi (2.0 bar) during spraying.
- Use included car charger for charging on-the-go.



Attaching the PTT to the Tank

- Remove the pumping mechanism and handle from the sprayer. Included with the PTT is a lid to cover the Primeline while the PTT is off of it and charging to prevent spillage and leakage. Remove lid, attach PTT to top of the tank.



PRESSURIZING TANK TOP (PTT)

User Manual



- PTT screws onto the top of the stainless steel tank; after 2 - 3 turns the top should be tight and secure. If the pump runs continuously, it is an indication that the tank top is not tight.

Turning the PTT On/Off

- Set and turn the PTT on the open top of the stainless steel tank. After approximately 2¾ turns, the PTT will be securely attached.
- Press On / Off switch to On to begin pressurizing a tank containing liquid formulation. Allow approximately 2.5 minutes to pressurize a 1-gallon tank containing 1 gallon of liquid. Switch should remain On while operating. Turn Off when tank is empty or spraying completed. **Note:** Slowly unscrew PTT from a pressurized tank to allow air to escape.

CARE, MAINTENANCE AND PARTS

Cleaning

- Periodically clean the underside of the PTT using a cloth wet with detergent solution. Remove formulation residue from the underside and the gasket (#22028000 / 1608003634).
- Inspect the tank gasket for cracks and replace when damaged. Insert gasket securely into the PTT to prevent it from coming loose when the tank is refilled.
- Clean around the pump outlet port (under side) to remove insecticide residue or other debris.



Replacing the Battery

- PTT must be removed from the tank and placed on a clean and dry surface. The On / Off switch must be in the Off position.
- Use a small hex wrench and an open-end wrench to remove the screws that are visible from the underside of the tank top.
- When both screws are removed the top of the unit can be removed by pulling on the padded handle. **Note:** Lift off the top carefully and do not damage the connection of the On / Off switch wire.
- Disconnect the 2-pin connector attached to the top of the battery and pull the battery pack up from its base.
- Insert a new battery pack and re-attach the 2-pin connector.
- Return the top to the base and re-connect the two screws on the sides.

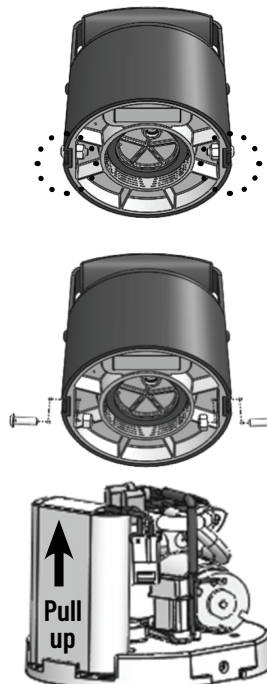

PARTS AND PARTS LIST



NUMBER	DESCRIPTION	LEGACY PART#	ORDER #
1	Battery pack	22046019	1608003775
2	Wall charger	22046001	1608003759
3	Foam curved handle grip	22046006	1608003764
4	Gasket	22028000	1608003634
NS	Car charger	22046027	1608010215
NS	PTT Cap Kit	22029710	1108004810

TROUBLESHOOTING

Problem	Solution
The PTT will not attach to the tank.	If it takes more than 3 turns to attach, the gasket on the underside of the tank top is missing or damaged. Do not operate the tank top without the gasket. Replace it with #22028000 / 1608003634.
Air is leaking from the tank.	PTT has a gasket on the underside that seals the tank top to the opening on the sprayer tank. The gasket seals the top of the sprayer tank to the bottom of the PTT, preventing air from leaking. Add silicone grease to the gasket to help tighten the seal.
Pump motor continuously runs.	Check that the gasket has not become loose or stuck to the top of the sprayer when the PTT is removed to fill the tank. Do not operate the PTT without the gasket.

STORAGE

To store the PTT remove from tank, wipe clean and store indoors in dry conditions.

DISPOSAL

United Kingdom / European Union

Private UK/ EU households: Information on Disposal for Users of WEEE



This symbol (Figure 5) on the product(s) and / or accompanying documents means that used electrical and electronic equipment (WEEE) should not be mixed with general household waste.

For proper treatment, recovery and recycling, please take this product (s) to designated collection points where it will be accepted free of charge. Alternatively, in some countries, you may be able to return your products to your local retailer upon purchase of an equivalent new product. Disposing of this product correctly will help save valuable resources and prevent any potential negative effects on human health and the environment, which could otherwise arise from inappropriate waste handling. Please contact your local authority for further details of your nearest designated collection point.

Penalties may be applicable for incorrect disposal of this waste, in accordance with your national legislation.

Professional Users in the European Union

If you wish to discard electrical and electronic equipment (EEE), please contact your dealer or supplier for further information.

All Other Countries

This symbol is only valid in the European Union (EU). If you wish to discard of this product, please contact your local authorities or dealer and ask for the correct method of disposal.

WARRANTY

Pelsis products are designed and manufactured to the highest standards and deliver high-quality performance, ease of use and ease of installation. If you encounter any difficulties while using your product, we recommend that you first consult the user manual or the information in the support section of our website. In the unlikely event of a fault, please contact your retailer or distributor for further warranty information.

Any warranty claims must be supported by proof of purchase within the warranty period (product dependent), the following exclusions apply:

- Normal wear & tear.
- Damage caused by abuse, misuse, alterations or by not completing the recommended maintenance.

This warranty does not affect your statutory rights.

CONTACT

Contact your local distributor or Pelsis country-specific location for information on spares and service.

US: B&G Equipment, 135 Region South, Jackson, GA, 30233, USA

Contact Number: 1-800-544-8811

Email Address: CustomerService@BGEquip.com

UK: Pelsis Ltd, Sterling House, Grimbold Crag Close, Knaresborough, HG5 8PJ, UK.

Contact Number: +44 (0) 800 988 5359

Europe: Pelsis Belgium NV, Industrieweg 15, 2880, Bornem, Belgium.

Contact Number: +32 (0) 3 886 22 11

All Other Countries: B&G Equipment, 135 Region South, Jackson, GA, 30233, USA

Contact Number: 1-678-688-5601

Email Address: CustomerService@BGEquip.com